

THE PROPERTY CO. GROUP



7b Harley Street Sylvania NSW

5 🚗 4 🚗 2 🚗

Expertly designed, this residence showcases modern elegance with a light-filled layout and desirable north-facing yard. Spacious interiors are finished with premium materials and flow seamlessly to a private entertainer's patio overlooking an inviting mineral swimming pool with striking waterfall feature. The flexible floorplan offers five bedrooms along with an additional upstairs sitting area ideal as a retreat or secondary living space. The master suite includes a walk-in robe and luxurious ensuite, creating a private sanctuary within the home.

- Custom curved stone kitchen with premium Smeg appliances and butler's pantry
- Sun-drenched north-facing aspect ensuring optimal natural light and year-round comfort

Type : Semi Detached

View : <https://www.thepropertyco.com.au/8631254>



Jason Mikhail
02 8320 6666



Jonas Kapsanis
02 8320 6666

[For full version visit the website](https://www.thepropertyco.com.au)

<https://www.thepropertyco.com.au>



SITE PLAN (NOT TO SCALE)

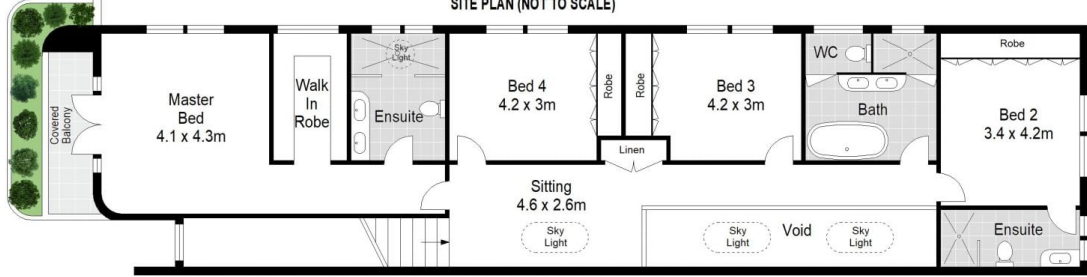

FIRST FLOOR

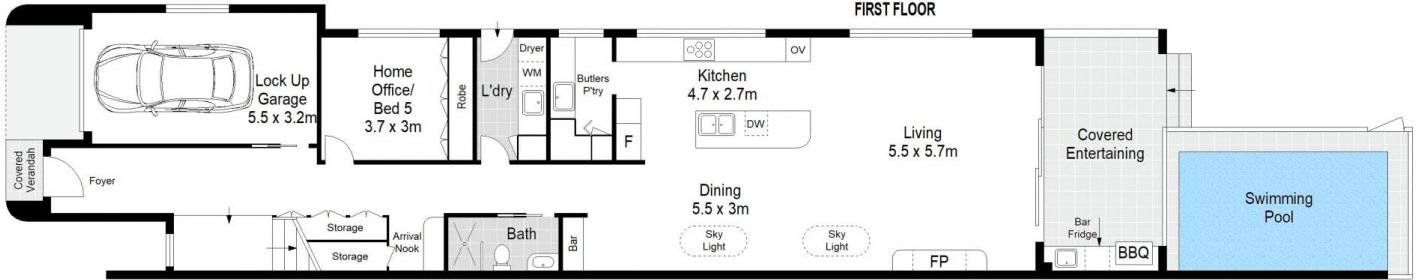

GROUND FLOOR

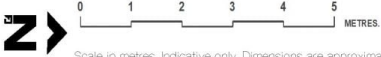

7b Harley Street, Sylvania



Scale in metres. Indicative only. Dimensions are approximate. All information contained herein is gathered from sources we believe to be reliable. However we cannot guarantee its accuracy and interested persons should rely on their own enquiries.