

# THE PROPERTY CO.

GROUP



**2/26 Marshall Road Kirrawee NSW**

4 2 4

The epitome of modern living, with luxurious living spaces and an abundance of natural light, this tastefully crafted and well-designed townhouse is built with easy care living in mind and showcases quality inclusions and finishes. The entry level of the home features galley style kitchen with 40mm stone bench tops, Bosch appliances and De Longi dishwasher, separate lounge and dining with perfect flow to patio and grassed yard, ideal for entertaining friends and family. Upstairs offers four generous bedrooms with built in robes, master suite with walk in robe, ensuite and balcony, plus luxurious main bathroom with quality finishes. Adding to the convenience is remote control double lock up garage with internal access, third toilet downstairs and located approximately 100m to the bus stop and 2km to Kirrawee shops, cafes and train station.

**View :** <https://www.thepropertyco.com.au/7978315>

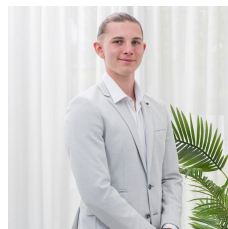

**Jordan Olar**  
**02 8320 6666**

- Set at front of boutique complex of four townhouses

<https://www.thepropertyco.com.au>

GROUND FLOOR

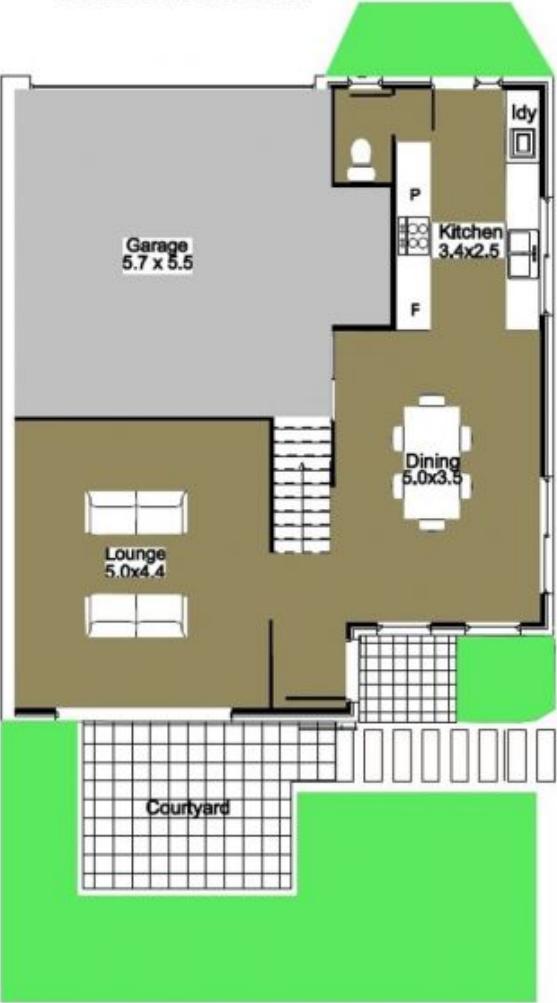

FIRST FLOOR



TOWNHOUSE 2